

# How to install Window Frosting

Recommended  
**Two  
person  
install**

**Syba**  
SIGNS

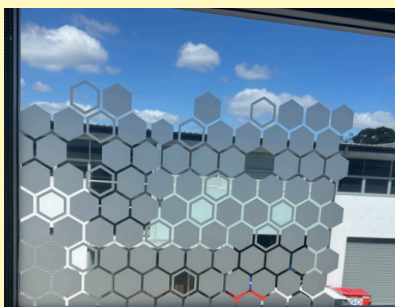

Before starting, make sure the windows have been cleaned and are fully dry.

Double check the frosting panel fits your window. If not, make any adjustments to the panel before application. You will be installing frosting from left to right so adjust the right hand side edge if required with a straight edge / ruler and craft knife.

**1** Before applying the frosting to the window find a clean flat surface and with the application tape side up, use the squeegee supplied to firmly smooth out the material to ensure the frosting is firmly adhered to the application tape.

**2** Remaining on the clean, flat surface, turn the frosting over and peel the first 10-15cm of the backing paper away exposing the adhesive side. Fold the backing paper over against itself. Make sure the frosting stays on the application tape.

**3** Position the frosting in place on the window, starting at the left side and work your way across. Just don't let the adhesive side fold over onto itself.

**4** Once you are happy with the position you can slowly peel the backing paper away from the frosting (you can do this in 30cm sections). Move slowly and keep checking the frosting is coming off the backing paper and remaining on the application tape. If any pieces of frosting are left on backing paper they can be individually applied by hand once you complete the full process.

**5** As you peel the backing paper away in 30cm sections, smooth it onto the window as you go with the squeegee supplied moving from the centre out to the edges being careful not to create air bubbles.

**6** Once you have the full frosting panel in place firmly smooth over the full panel with the squeegee supplied. Finally, slowly remove the application tape leaving the frosting on the window. Remove application tape and smooth over the frosting again pushing remaining bubbles out to nearest edge.

**If joining multiple panels to create a continuous design**  
Please view our multiple panel instructions.

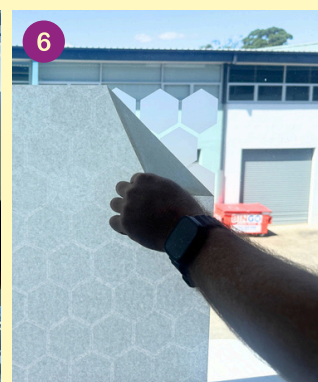
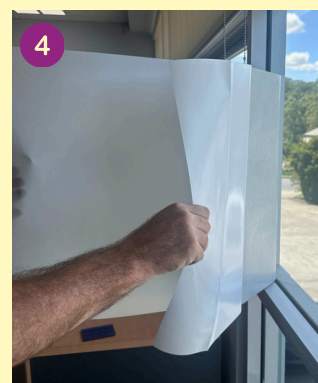
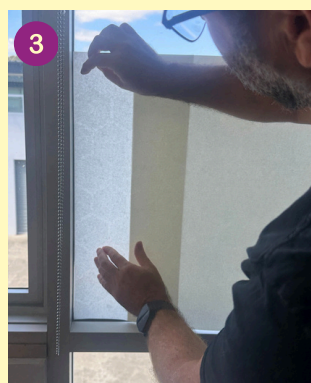
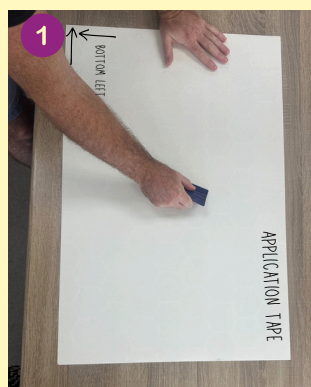

## Care Instructions:

Windows can be washed normally.  
Avoid harsh chemicals.